

ADDITIONAL UNI OVER HEAD FLASHING

TIMBER FRAMING

SECOND LAYER OF **UNI** FIXED OVER HEAD FLASHING UPSTAND WITH **UNI** CAP NAILS

HEAD FLASHING OVER **UNI** OR **UNI FR**

MASONS 40 BELOW PLATINUM OR FLEX FLASHING TAPE INSTALLED AS PER MANUFACTURERS INSTRUCTIONS

PRIMARY LAYER OF **UNI** DRESSED INTO OPENING

WINDOW JOINERY

UNI FAB & UNI PLUS
MANDATORY FOR VERY HIGH AND EXTRA HIGH WIND ZONE. RECOMMENDED FOR ALL WIND ZONES

UNI PRO
MANDATORY FOR ALL WIND ZONES

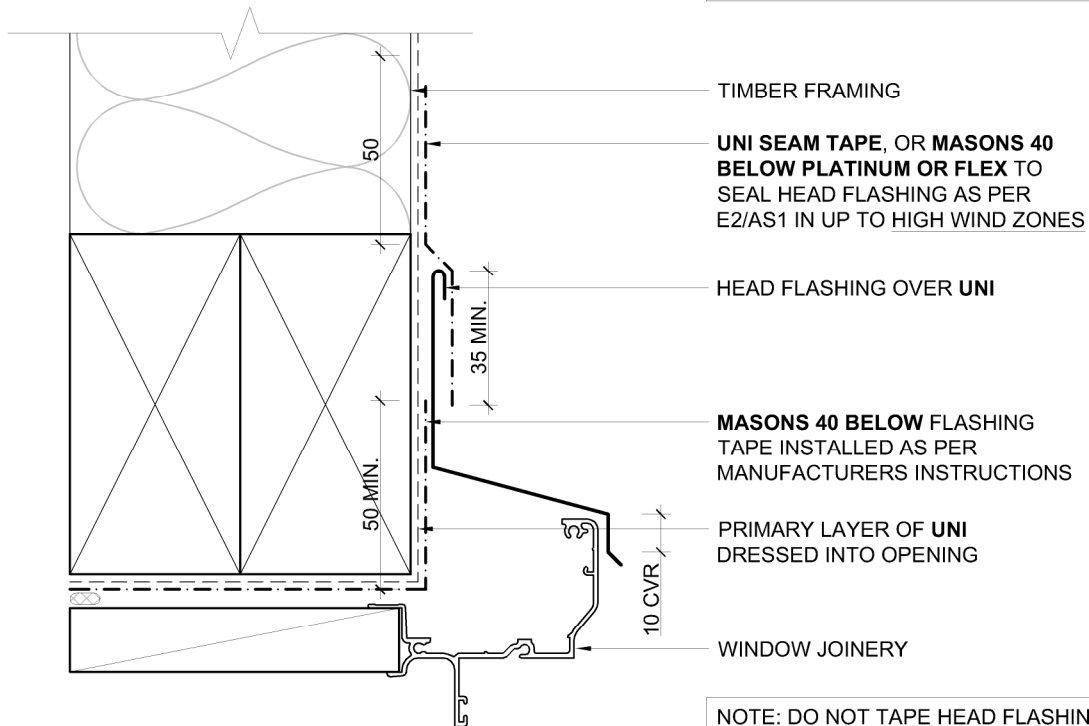

FLASHING TAPE OVER HEAD FLASHING

TIMBER FRAMING

UNI SEAM TAPE, OR MASONS 40 BELOW PLATINUM OR FLEX TO SEAL HEAD FLASHING AS PER E2/AS1 IN UP TO HIGH WIND ZONES

HEAD FLASHING OVER **UNI**

MASONS 40 BELOW FLASHING TAPE INSTALLED AS PER MANUFACTURERS INSTRUCTIONS

PRIMARY LAYER OF **UNI** DRESSED INTO OPENING

WINDOW JOINERY

NOTE: DO NOT TAPE HEAD FLASHING ON **UNI PRO**. USE ADDITIONAL LAYER OF **UNI** TO ALL WIND ZONES



Window Head
Head Flashing to UNI FAB, UNI Plus & UNI Pro

Scale

1:2

Date

Drawing Ref No.

UNI.04