

# Cladding Vents

## Weephole Vents

### Brick Vent



A purpose designed plastic vent for use in masonry veneer construction to provide a neat clear air passage for the removal of moisture, and the circulation of air to vent the cavity.

'The Brick Vent' can be used in conjunction with any cladding system that requires a ventilated cavity, including, bricks, blocks, and stone.

#### KLA Vent - Advantages

- Facilitates the removal of water from the cavity.
- The cavity tray ensures the weep hole cannot be blocked.
- The Brick Vent provides a standard 10 mm gap between masonry.
- The cavity tray directs air flow up the cavity removing moist air.
- Comes in grey and cream to match most mortar colours.
- Designed to vermin-proof the weep hole and restrict driving rain.

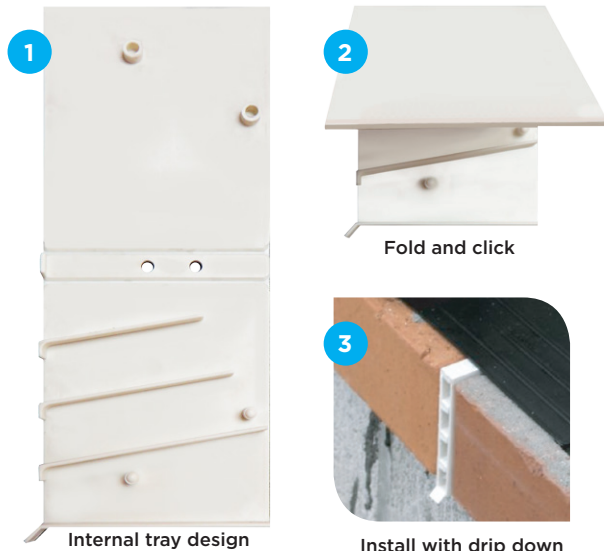

Description	Colour	Quantity	Masons Code
KLA Stone vent	STONE	150	KLA STONE
KLA Gray cavity vent	GRAY	150	KLA GRAY

### Aluminium Vent

Used for covering weepholes on plaster clad buildings

This aluminium vent is installed over the buildings weep holes to prevent vermin entering the cavity and to give the plaster exterior a tidy finish. The vent can be painted to blend in with the exterior.

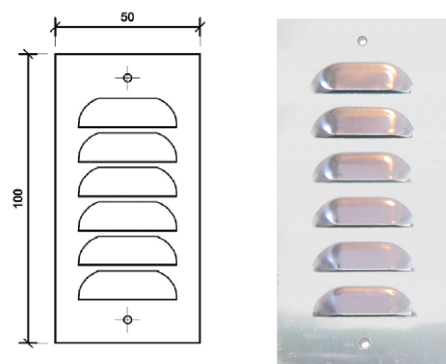

ALUMINIUM WEEPHOLE VENTS

Description	Quantity	Masons Code
Vent 100x50mm (metal louvre)	25	VENT